

1967 - 68 Firebird Hood Tach Location (1st type- tall)

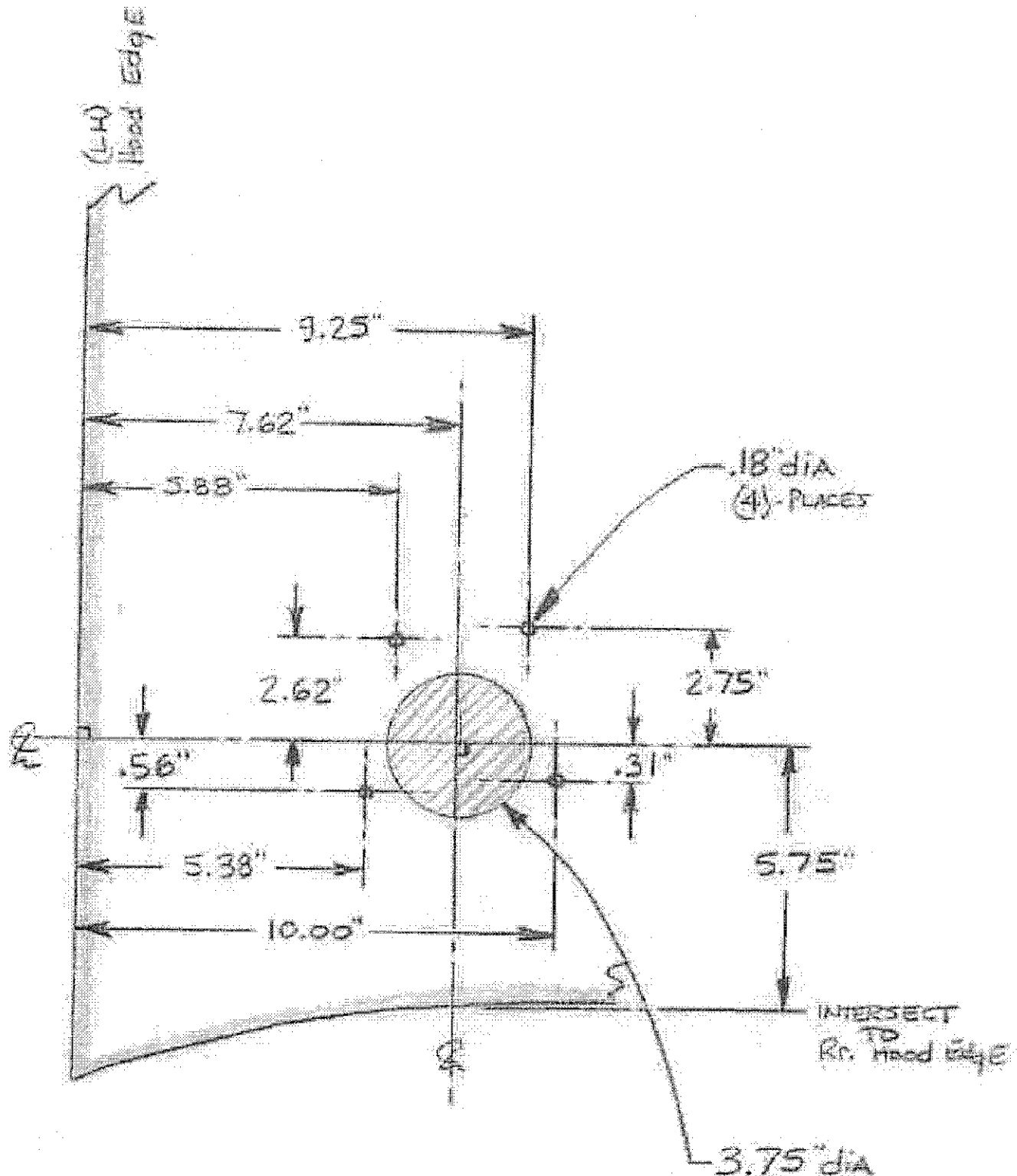

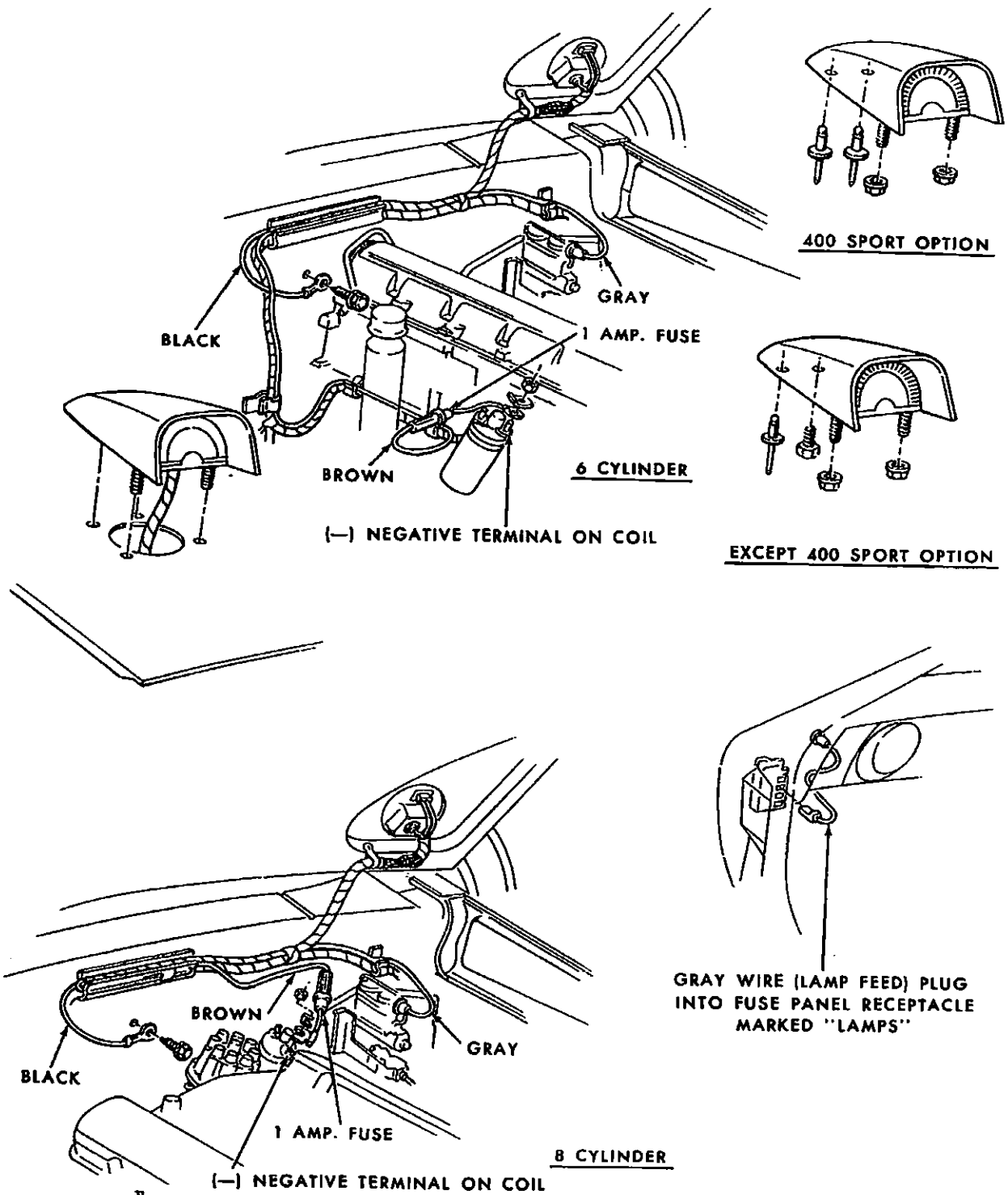
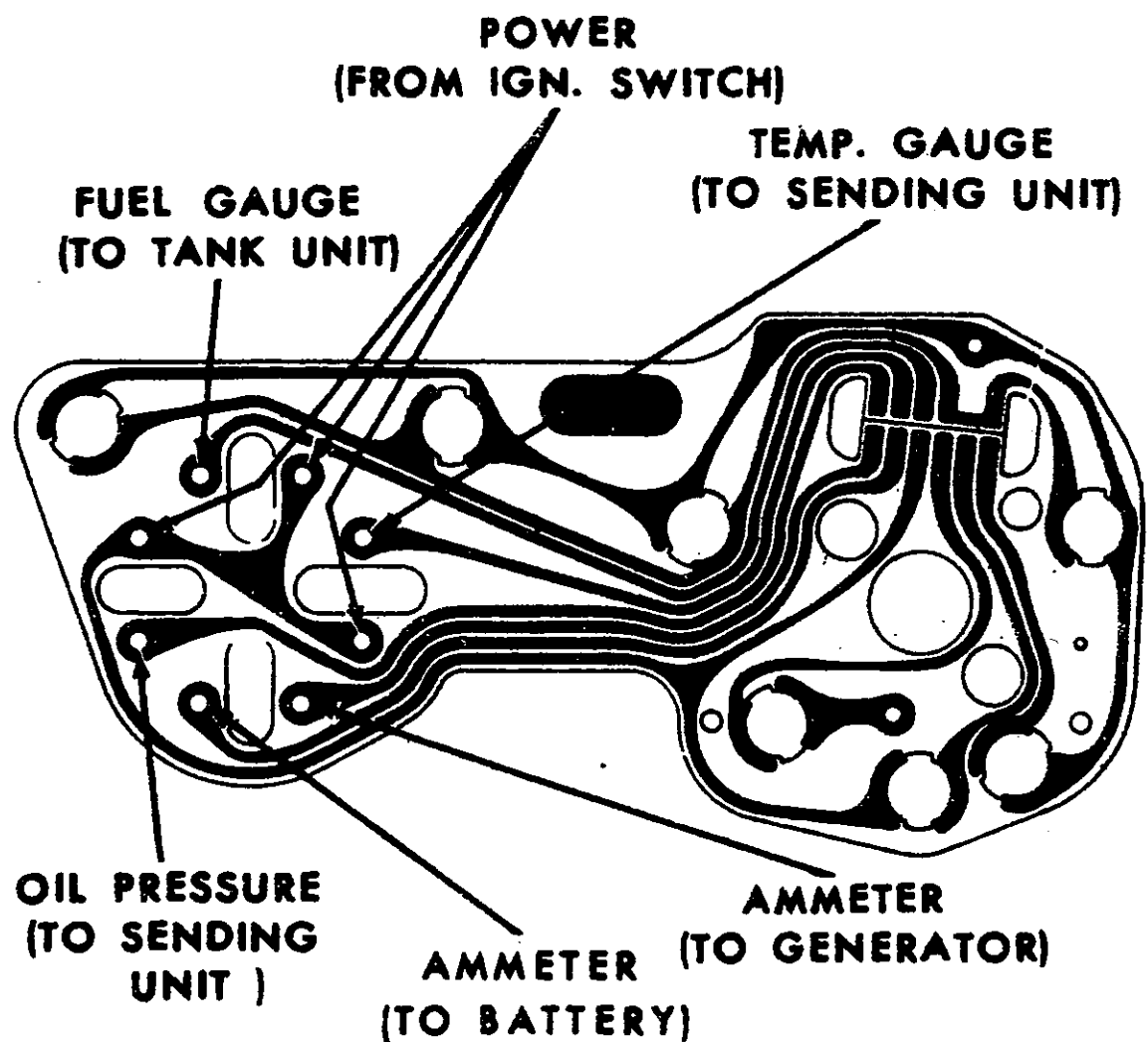

Fig. 15-4 Hood Mounted Tachometer



REAR VIEW OF PRINTED CIRCUIT

68 F/B

8/7

&d

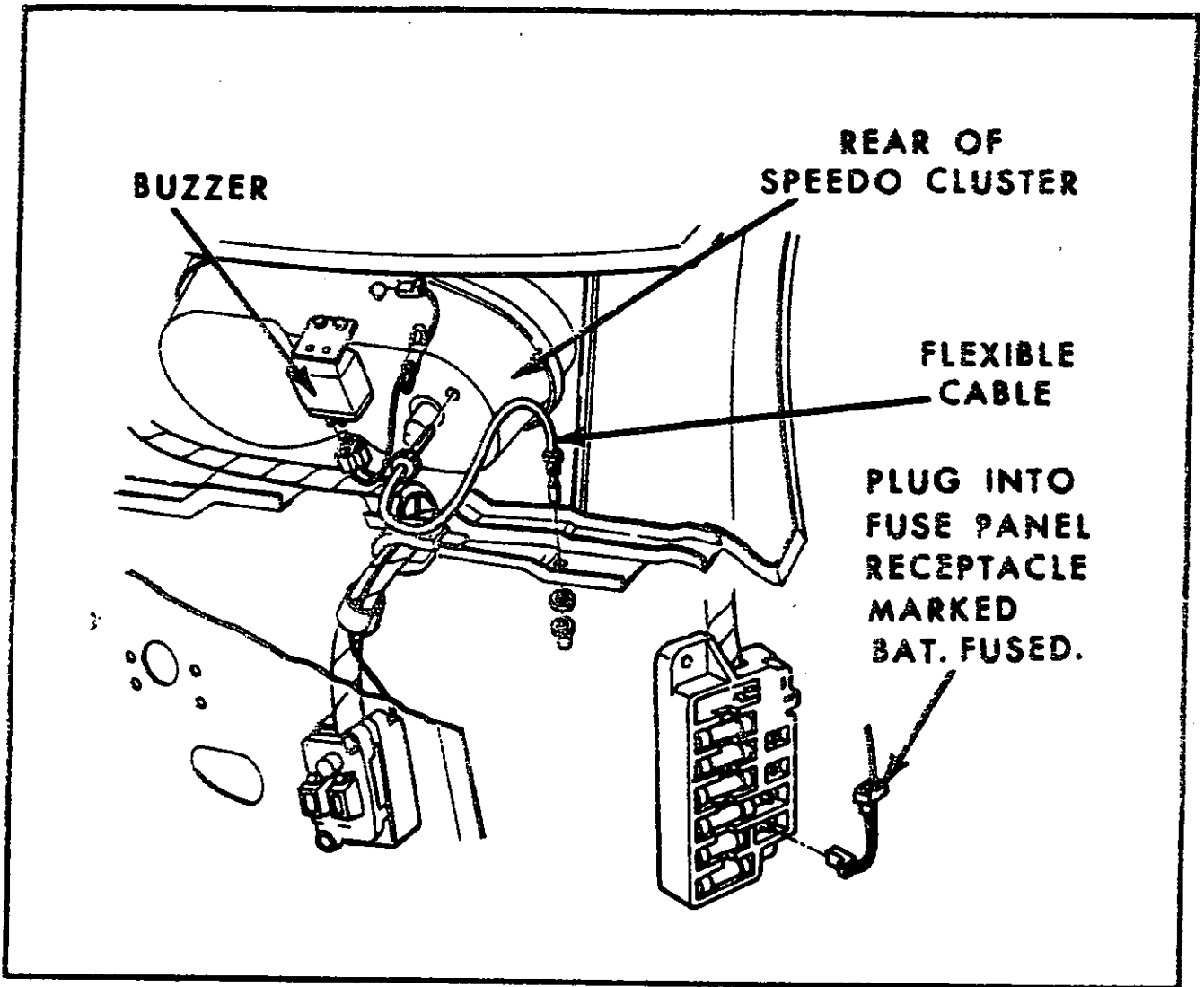

68 SPEED
WARNING

82
WARRING
29392

ACCESSORIES

CONTENTS OF THIS SECTION

SUBJECT	PAGE	SUBJECT	PAGE
Electric Clock	15-1	Radio Front and Rear Antennas	15-9
Description	15-1	Stereo Tape Player	15-10
Clock - Remove and Install	15-1	Description	15-10
Safeguard Speedometer	15-1	Maintenance and Cautions	15-10
Rear Window Defogger	15-9	Trouble Diagnosis	15-10
Hood Mounted Tachometer	15-9	Tape Player	15-10
Radio	15-9	Stereo Speakers	15-11
Description	15-9	Multiplex Adapter	15-11
Adjust Antenna Trimmer	15-9	Multiplex Adapter - Remove and Replace ..	15-13
Radio Trouble Diagnosis	15-9	Multiplex - Tape Player Switch	15-13
Radio Receiver	15-9	Switch - Removal and Installation	15-16
Radio Front Speaker	15-9	Console	15-16
Radio Rear Speaker	15-9	Description	15-16
Radio Rear Speaker Fader Control	15-9	Remove and Replace	15-16

ELECTRIC CLOCK

GENERAL DESCRIPTION

Refer to 1967 Pontiac Service Manual Page 15-1 for description of operation of Firebird clock and instructions on setting time.

CLOCK-REMOVE AND INSTALL

1. Remove two screws holding clock to clock housing and pull clock out of housing (see Fig. 15-1).

2. Unplug two-wire connector and bulb socket.

3. To install-reverse above.

SAFEGUARD SPEEDOMETER

The Firebird safeguard speedometer has an indicator pointer incorporated into the speedometer dial. This pointer is set at the desired speed by means of a flexible cable with a knob at the underside of the instrument panel. When car speed exceeds set speed, the buzzer mounted on the back of the speedo cluster will sound. See figure 15-2 for service of components.

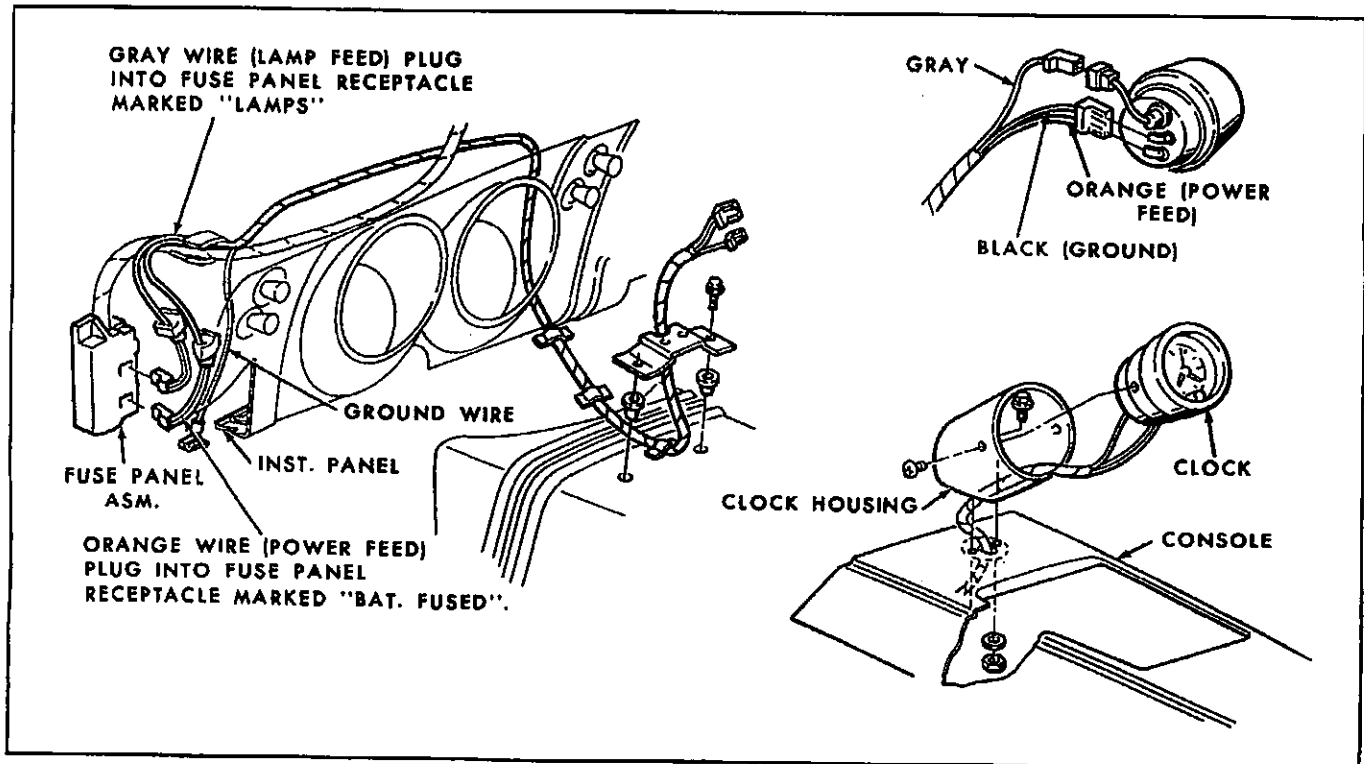

Fig. 15-1 Electric Clock

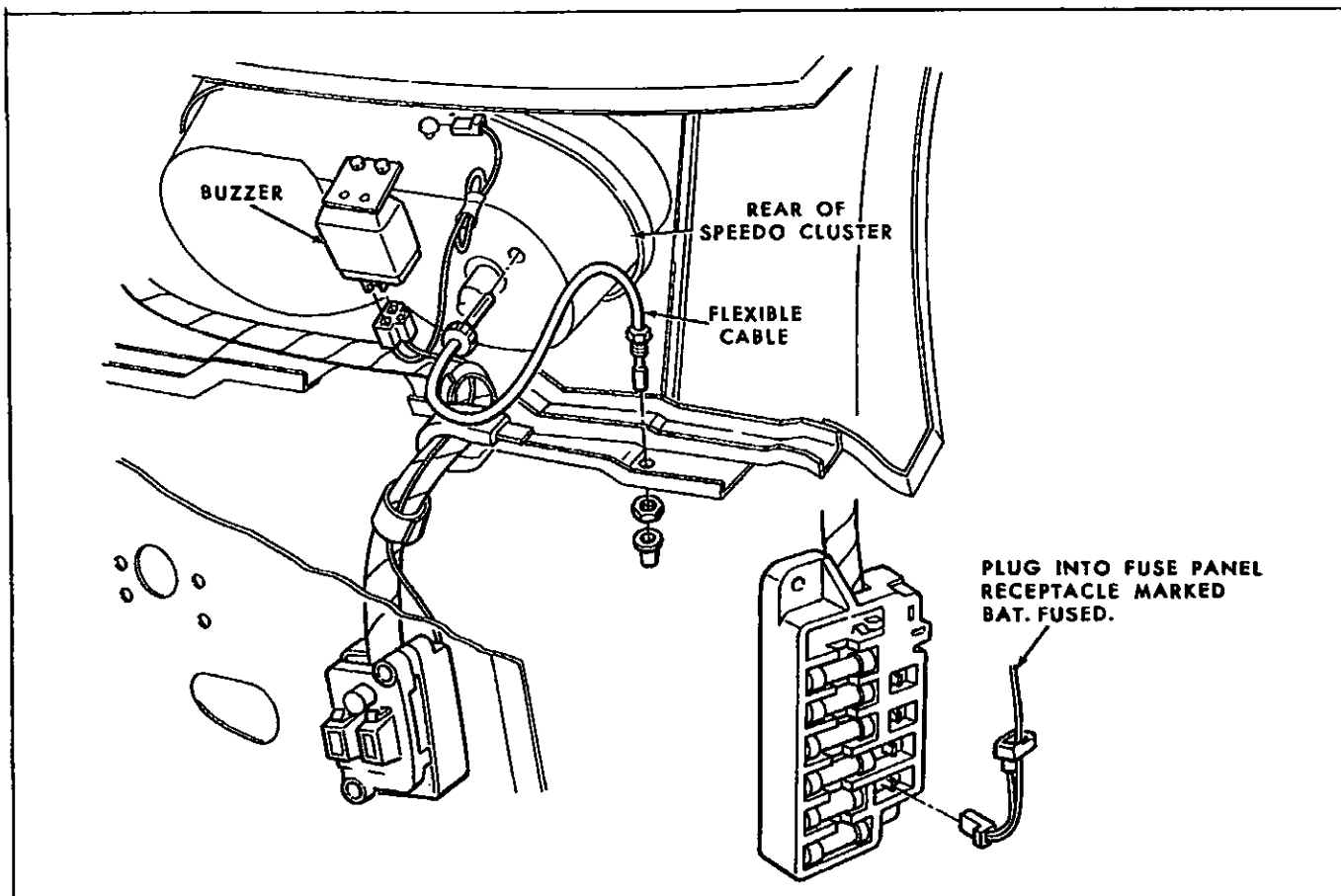

Fig. 15-2 Safeguard Speedometer

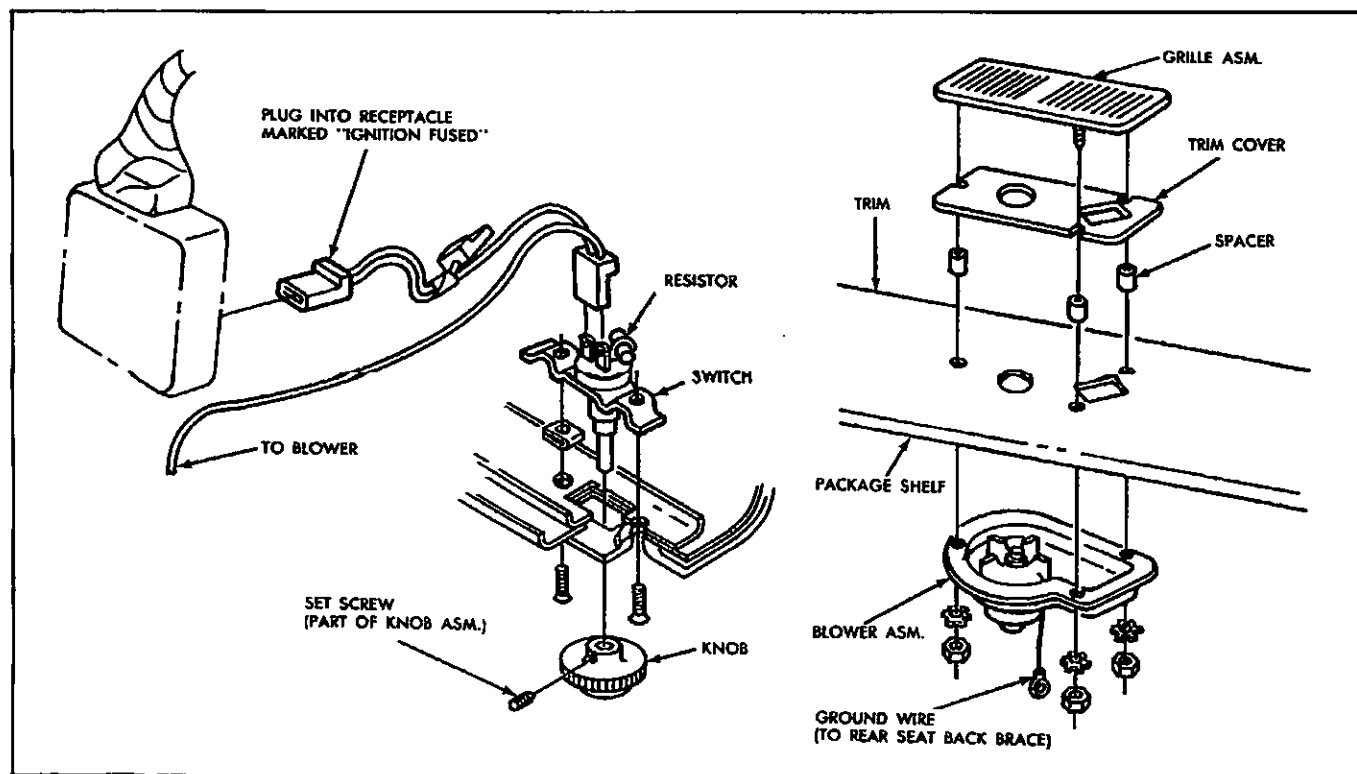

Fig. 15-3 Rear Window Defogger

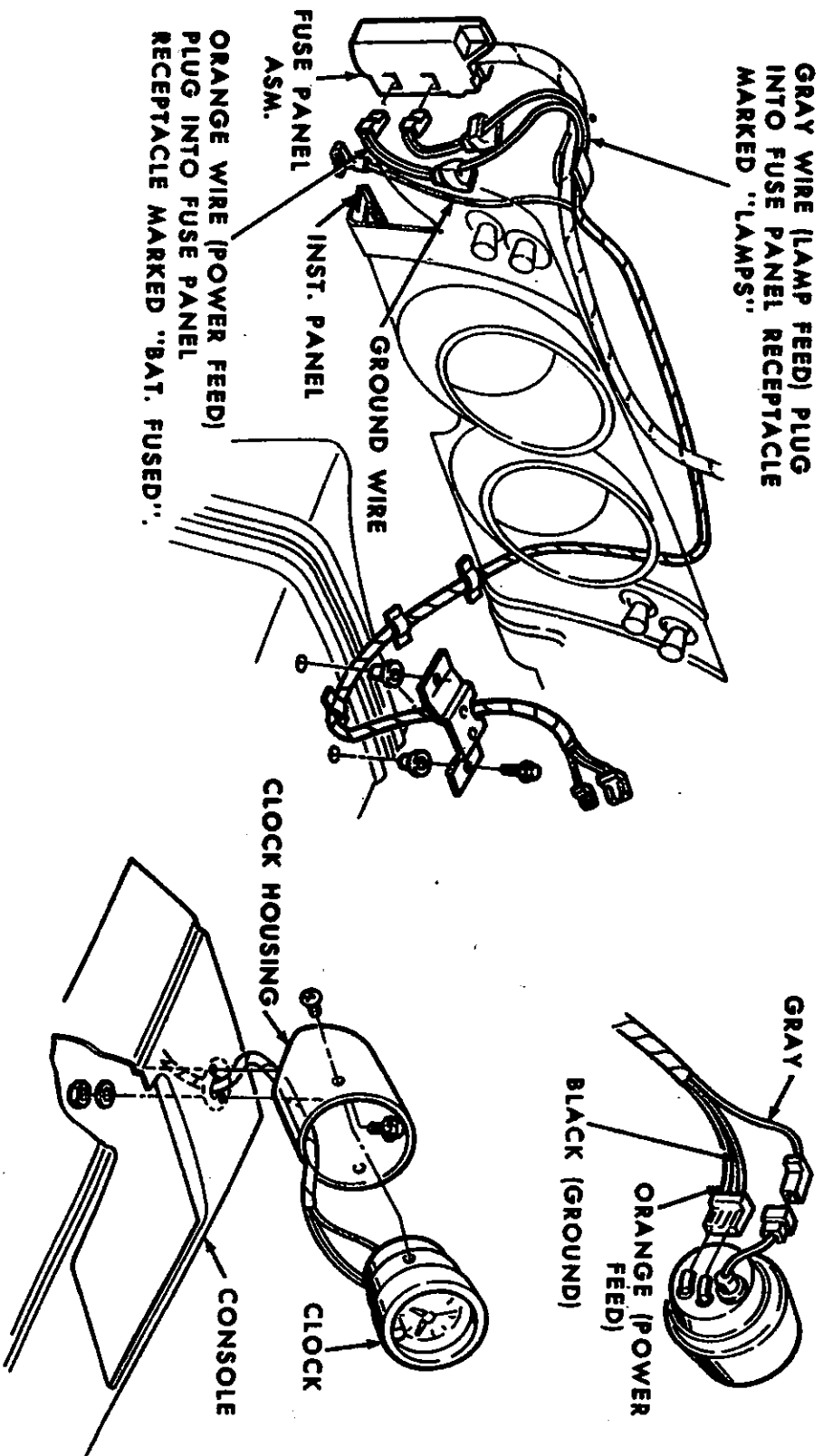
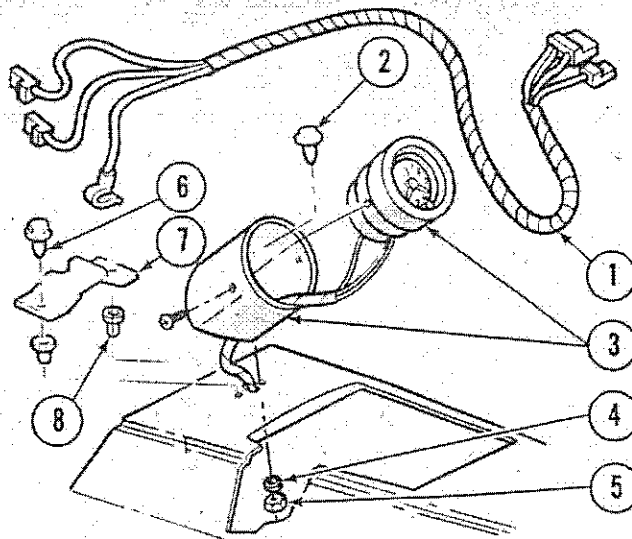

Fig. 15-12 Clock Installation—Firebird

PP9-81



PP9-81

1967-68 FIREBIRD FLOOR MOUNTED CLOCK (EXC 1968 CONSOLE)

1. WIRE ASM., Floor Mounted Clock	9.772	3. CLOCK ASM., Floor Mounted	9.772
2. SCREW, Clock to Console (#10-24 x 1")	8.977	4. WASHER, Flat (1/4" ID x 9/16" OD) ..	8.929
SCREW, Clock to Floor Brkt (#10-23 x 1/2")	8.977	5. NUT, Hex (#10-24)	8.915
		6. SCREW, Hex Tap (#10-32 x 5/8")	8.977
		7. BRACKET, Floor Mounted Clock	9.772
		8. NUT, Self Sealing (#10-32 Spec)	8.924

PP9-82

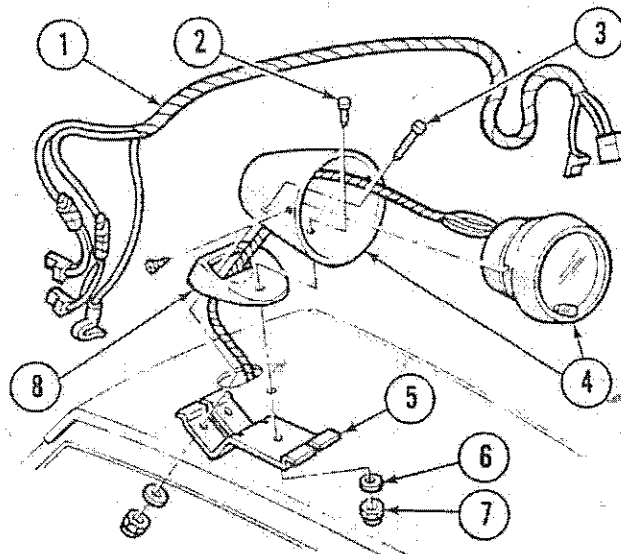

PP9-82

1968 FIREBIRD FLOOR MOUNTED CLOCK (W/CONSOLE)

1. WIRE ASM., Floor Mounted Clock	9.772	4. CLOCK ASM., Floor Mounted	9.772
2. SCREW, Clock to Console (#10-24 x 1")	8.977	5. BRACKET, Clock to Console	9.772
3. SCREW, Clock to Console (#10-24 x 2")	8.977	6. WASHER, Flat (7/32" ID x 1/2")	8.929
		7. NUT, Hex (#10-24)	8.915
		8. ADAPTER, Clock to Console	9.772

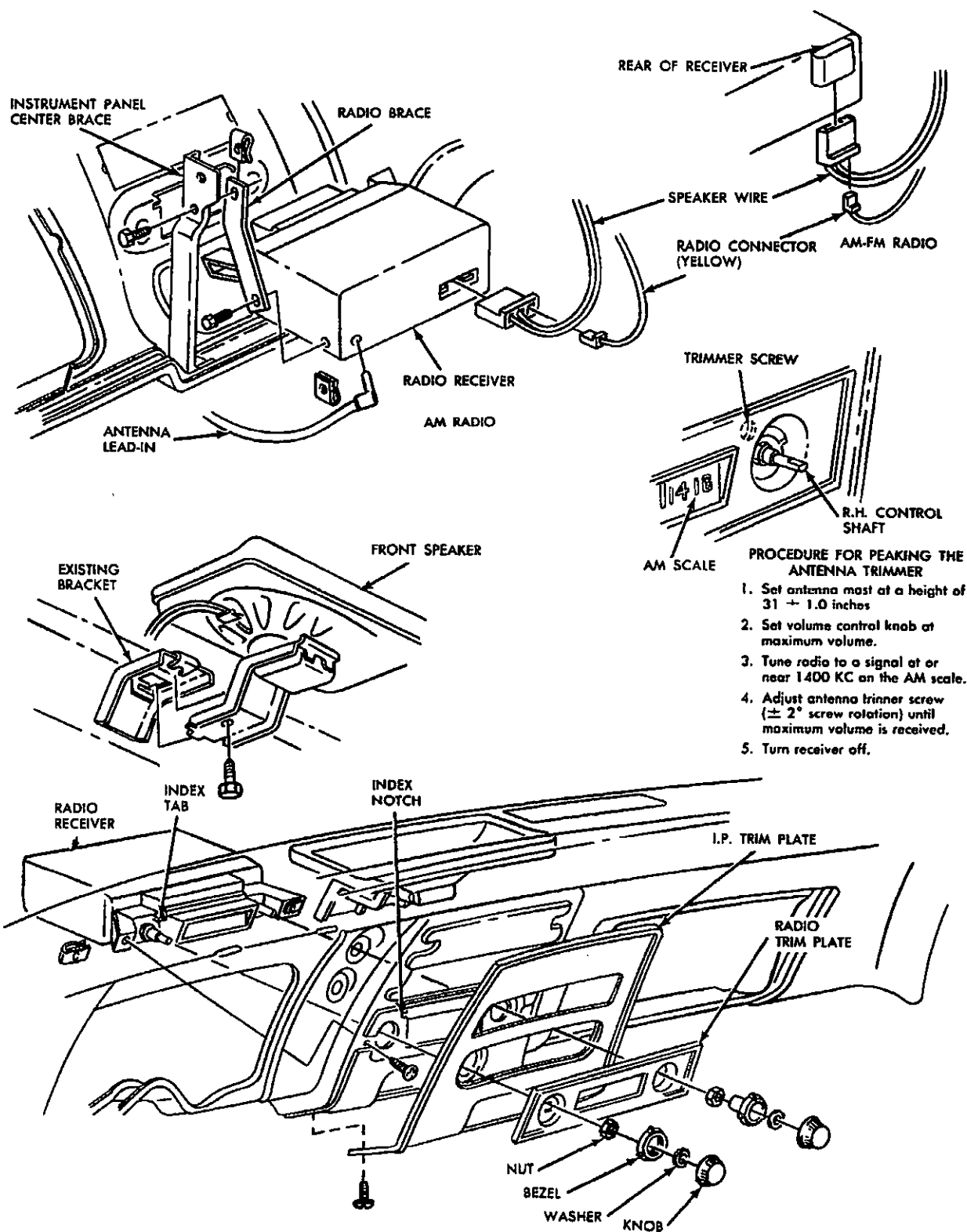

Fig. 15-5 Radio Receiver Installation

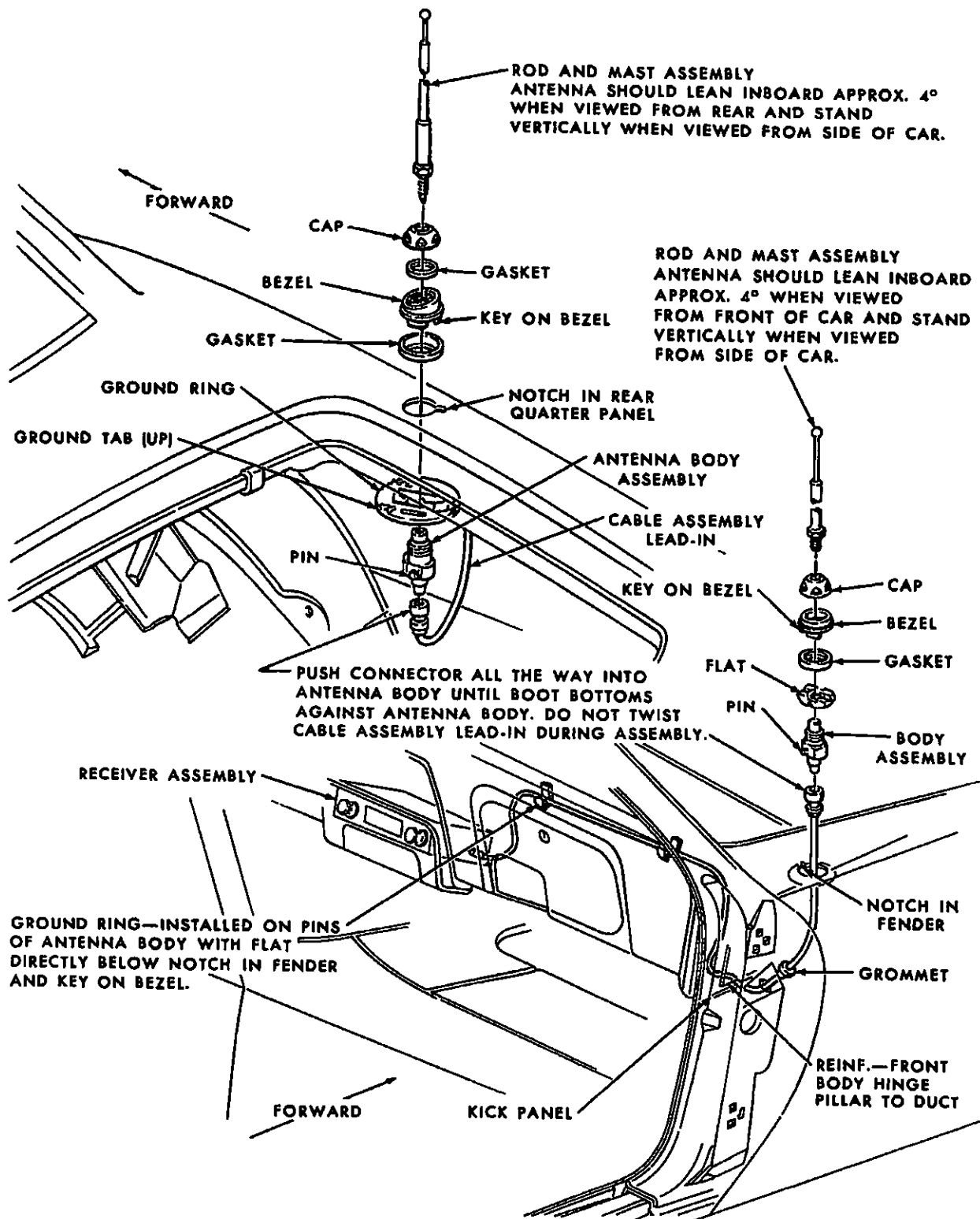

Fig. 15-6 Radio Antenna Installation

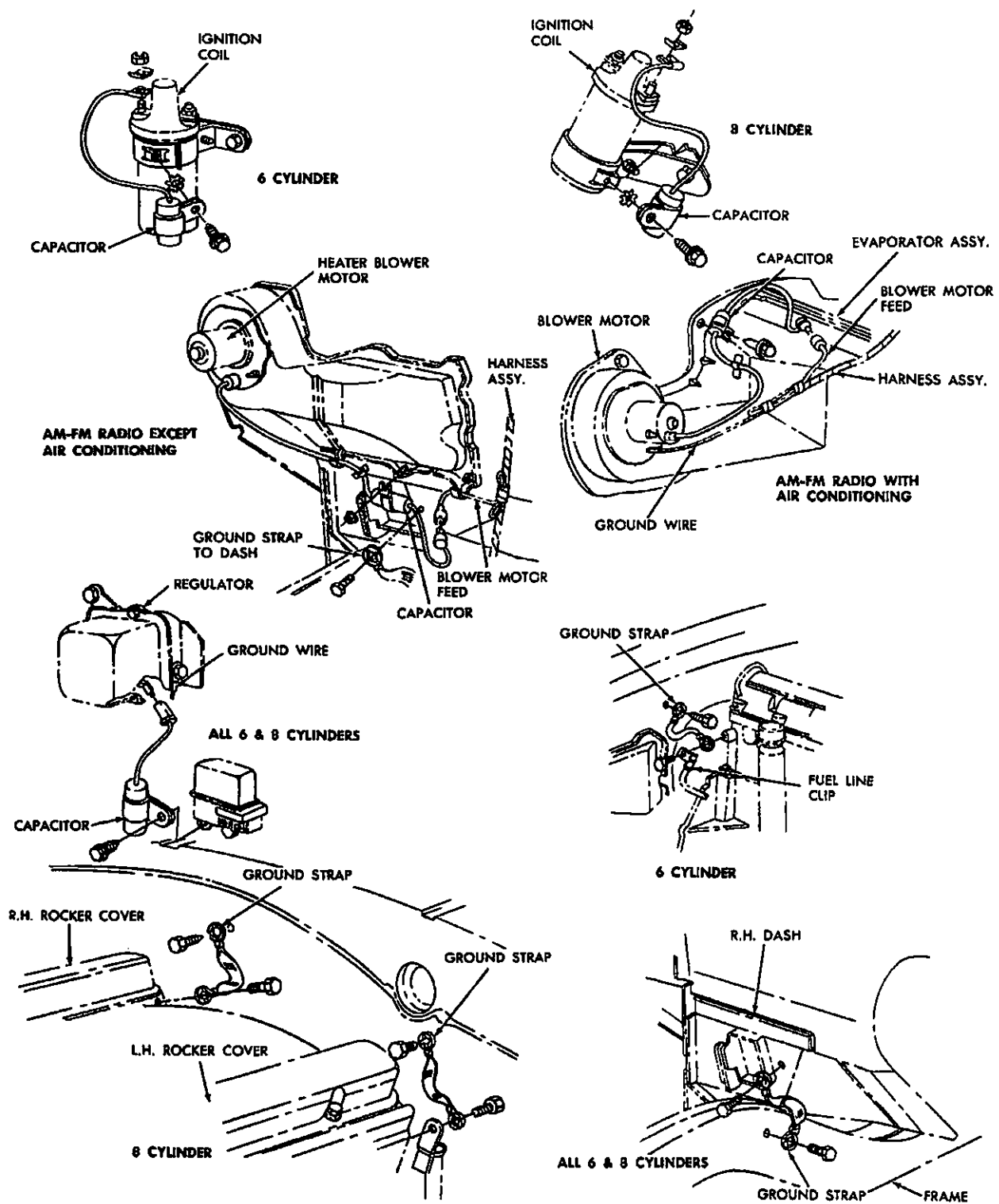

Fig. 15-7 Radio Suppression Equipment

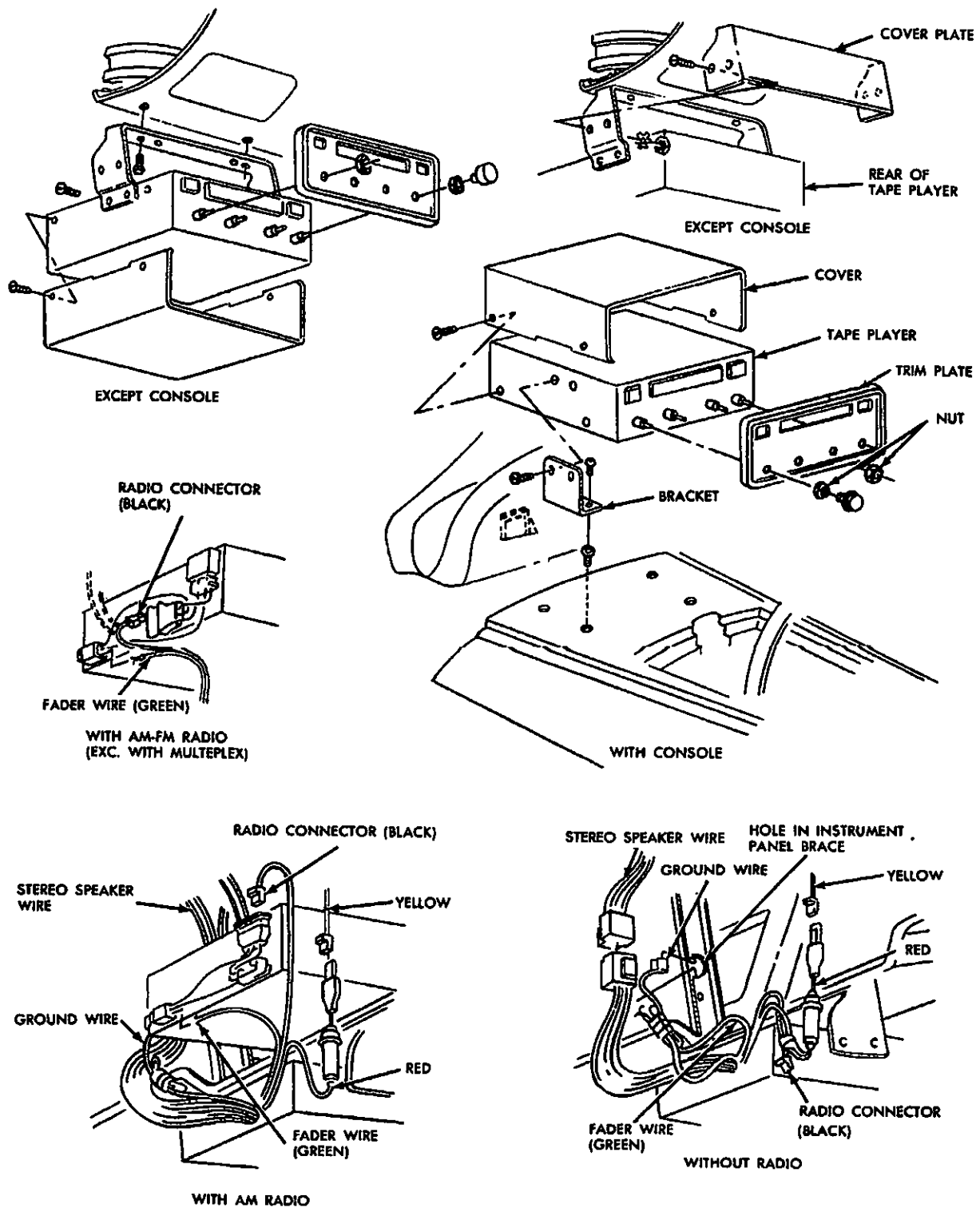

Fig. 15-8 Stereo Tape Player

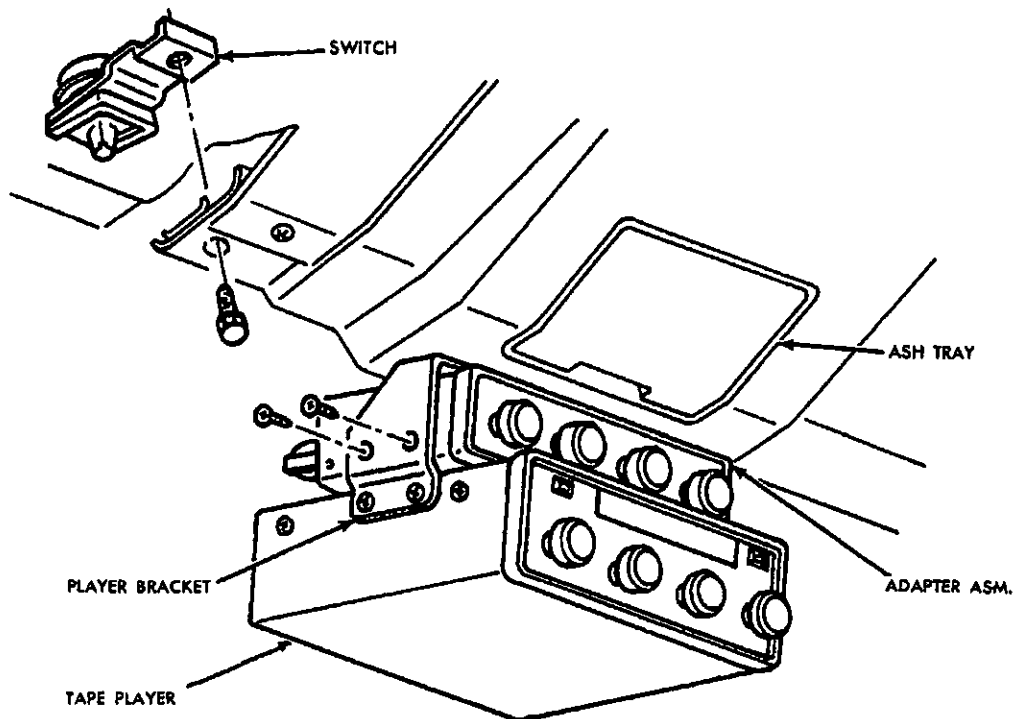
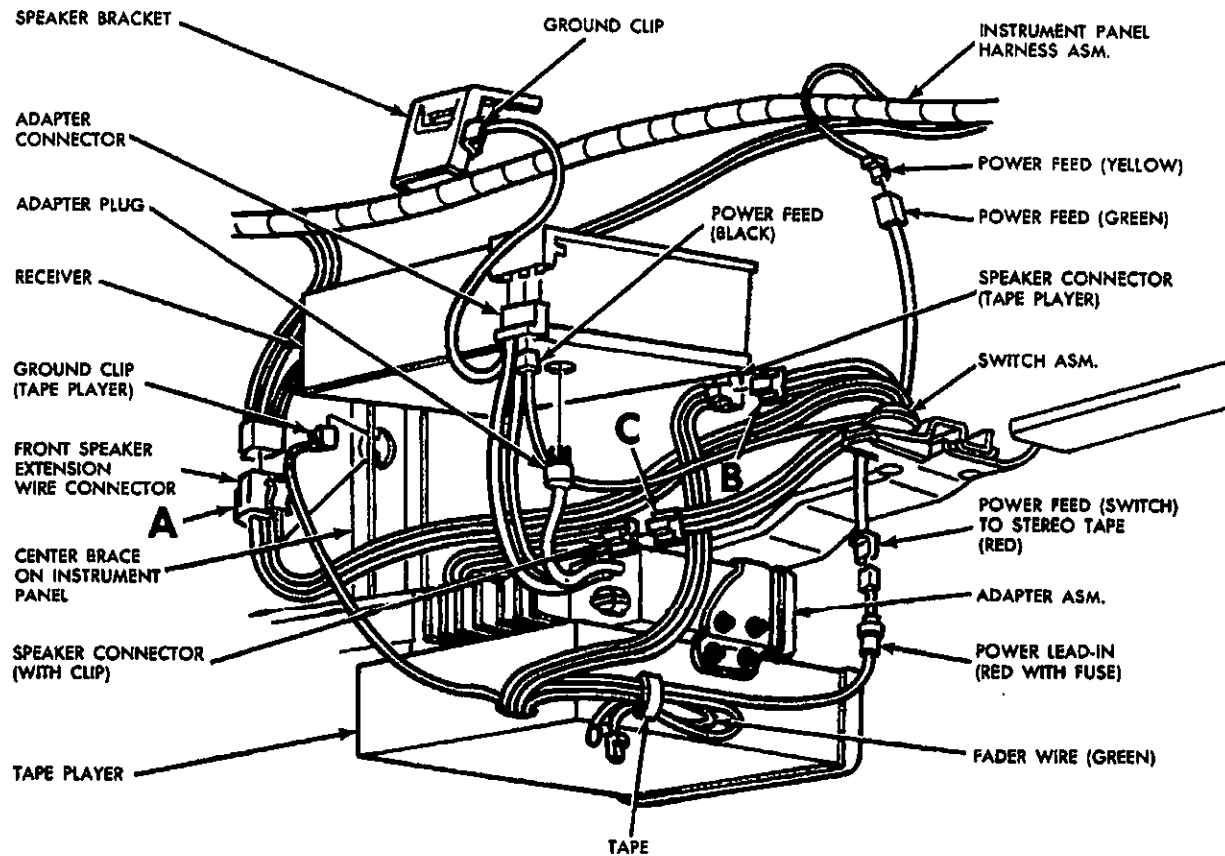

Fig. 15-9 Stereo Tape Player with Multiplex

REAR WINDOW DEFOGGER

The rear window defogger mounted under the rear package shelf provides for rapid defogging of the rear window. The blower control switch, located on the instrument panel, is manually controlled and may be operated on either hi or lo speed as required. Lo speed is provided by means of a resistor mounted on the control switch.

See Fig. 15-3 for service of individual components.

HOOD MOUNTED TACHOMETER

The tachometer indicates speed of the engine in revolutions per minute. The engine can safely be operated up to a maximum RPM as indicated by the start of the red bar. Engine operation causing tachometer indications in the red area can lead to serious engine damage.

See Fig. 15-4 for service of individual components.

RADIO

GENERAL DESCRIPTION

Two radios are available for Firebird -AM with pushbutton tuning, and AM-FM. These radios are both completely transistorized. AM or FM (on AM-FM Radio) may be selected by moving the knob in the center of the dial either right or left. The letters AM or FM will appear in the center of the dial indicating the band selected.

This (AM-FM) radio may be used in conjunction with a multiplex adapter and the stereo speakers to provide stereo FM reception.

For further description of radio, refer to Page 15-3 of the 1967 Pontiac Service Manual.

ADJUST ANTENNA TRIMMER

Refer to Page 15-6 of the 1967 Pontiac Service Manual for description of the trimming operation. To gain access to the trimmer screw on Firebird, remove radio trim plate (see Fig. 15-5). The screw is near the R.H. control shaft.

RADIO TROUBLE DIAGNOSIS

Refer to Pages 15-4 and 15-5 of the 1967 Pontiac Service Manual for radio trouble diagnosis guide. Refer to Figure 15-7 in this manual for installation of radio suppression equipment.

RADIO RECEIVER REMOVAL AND INSTALLATION

1. Remove tape player and/or multiplex adapter if so equipped.

2. Remove radio knobs by pulling straight out. Remove bezels, nuts, and radio trim plate (see Fig. 15-5).

3. Remove ash tray.

4. Remove four screws from lower edge of I.P. trim plate (two retain ash tray housing). Remove trim plate by pulling bottom of plate outward and upward to disengage from plastic retainer at top of I.P.

5. On A/C cars -

a. Remove right and left hand hoses from distribution ducts to I.P. outlets.

b. Remove center distribution duct and left hand plenum together (see Fig. 1B-7).

6. Remove one screw from ash tray housing and remove housing.

7. Disconnect all leads to radio receiver.

8. Remove radio brace to receiver screw.

9. Remove two screws at sides of radio controls, and lower receiver out left side of I.P.

10. Reverse above procedure to install.

11. If radio receiver was removed for service, re-adjust trimmer.

Whenever the AM-FM Radio, that is fitted with a multiplex adapter, is removed for service, the multiplex adapter should also be sent to the radio service station, since the problem could originate in either unit.

CAUTION: Never operate AM-FM Radio without either jumper plug (G.M. part 7292146 or equivalent) or multiplex adapter plug plugged into radio receiver.

RADIO FRONT SPEAKER - REMOVAL AND INSTALLATION

1. Remove radio receiver.

2. Remove four screws holding heater control to I.P. and let control hang by cables.

3. Remove screw holding speaker bracket to I.P. bracket, and remove speaker (see Fig. 15-5).

4. To install-reverse above procedure.

RADIO REAR SPEAKER - REMOVAL AND INSTALLATION

See Fig. 15-11 for details.

RADIO REAR SPEAKER FADER CONTROL - REMOVAL AND INSTALLATION

See Fig. 15-12 for details.

RADIO FRONT AND REAR ANTENNAS - REMOVAL AND INSTALLATION

See Fig. 15-6 for details.

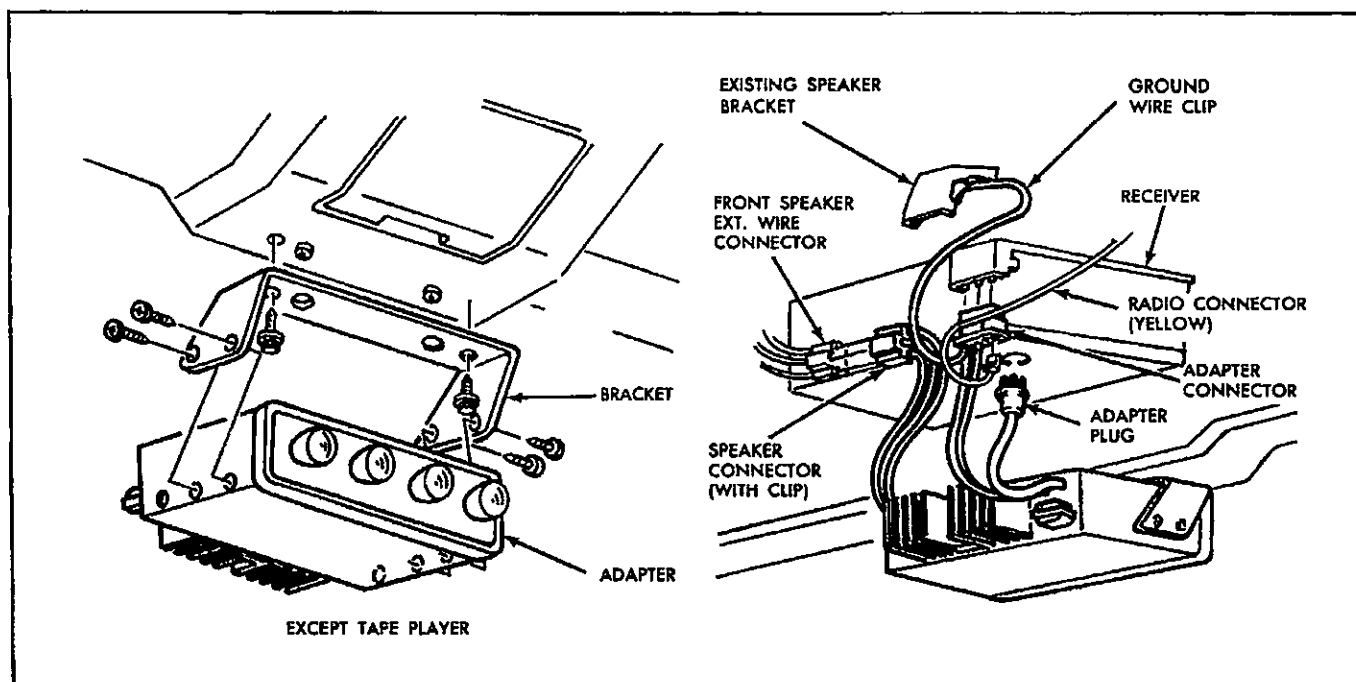

Fig. 15-10 Multiplex Adapter Installation (Except with Tape Player)

STEREO TAPE PLAYER

GENERAL DESCRIPTION

The Firebird tape player is used with four speakers, two front and two rear. The left front and right rear speakers are on one channel, and the right front and left rear on the other. For further description of the tape player, see Page 15-8 of the 1967 Pontiac Service Manual.

MAINTENANCE AND CAUTIONS

No periodic maintenance of the tape player is required. With use, however, lubricant and oxide from the player may build up on the capstan, head, and tape guide. This may cause the tape to slip or run slowly. These parts should be cleaned using a cotton-tipped swab and rubbing alcohol.

No lubricants should be used since they will cause the player to operate improperly, especially at extreme temperatures.

Do not bring any magnetized tools near the tape head. If the head becomes magnetized, every cartridge played in the player will be degraded.

ALWAYS PULL CARTRIDGE APPROXIMATELY ONE INCH OUT OF TAPE PLAYER WHEN NOT IN USE. IF THIS IS NOT DONE, THE TAPE MAY BE PULLED OUT OF THE CARTRIDGE AND WOUND AROUND THE CAPSTAN WHEN PLAYER IS RESTARTED.

TROUBLE DIAGNOSIS

The speakers and front-rear and balance controls may be checked as follows:

Turn controls as indicated below and if operating properly, one and only one speaker will operate.

BALANCE CONTROL	FRONT-REAR CONTROL	SPEAKER
Right	Front	Right-Front
Right	Rear	Left-Rear
Left	Rear	Right-Rear
Left	Front	Left-Front

The tape player may be checked by using the diagnosis guide - Fig. 15-13 of the 1967 Pontiac Service Manual.

NOTE: Always try another cartridge in the tape player first, to eliminate the possibility of a defective cartridge.

TAPE PLAYER - REMOVAL AND INSTALLATION

(See Fig. 15-8)

1. Disconnect radio connector (black wire) from front speaker connector at back of radio.
2. Disconnect red lead (with fuse) from power feed connector (yellow wire). - (Red wire when also equipped with multiplex).
3. Unclip tape player ground wire from I.P. brace (right side of radio).
4. Disconnect fader lead (green wire) from connector at back of radio.
5. Disconnect tape player speaker connector (six-wire connector) from stereo speaker connector. If

See Figs. 15-11, 15-13, and 15-14 for details. The right rear stereo speaker is the same as the radio rear speaker. Mounting for left side is identical to right except for hook-up of wires.

STEREO SPEAKERS-REMOVAL AND INSTALLATION

9. To replace-reverse above procedure.
8. Remove four screws holding tape player to mounting bracket and remove tape player to tape player and remove cover.
7. Remove four screws holding tape player cover to tape player and remove cover.
6. Remove knobs and nuts from trim plate (Fig. 15-8) and remove trim plate.
5. Remove four screws holding tape player to mounting bracket and remove tape player to tape player and remove cover.
4. Remove four screws holding tape player to mounting bracket and remove tape player to tape player and remove cover.
3. Remove four screws holding tape player to mounting bracket and remove tape player to tape player and remove cover.
2. Remove four screws holding tape player to mounting bracket and remove tape player to tape player and remove cover.
1. Remove four screws holding tape player to mounting bracket and remove tape player to tape player and remove cover.

Fig. 15-11 Rear Speaker Installation

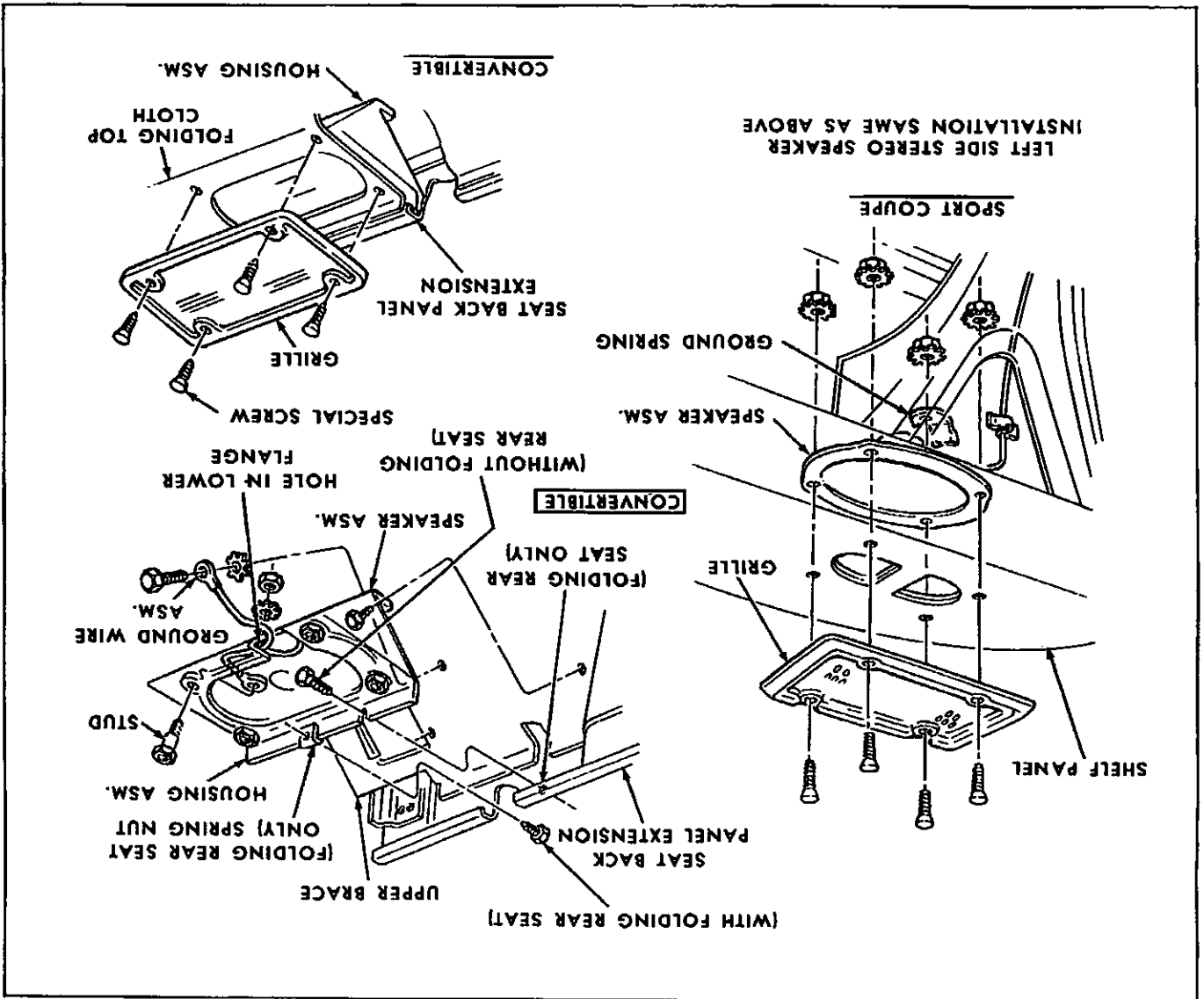

The stereo multiplex adapter permits FM stereo reception with the AM-FM radio. Radio controls are used to turn the set on and off and for station selection. Controls on the adapter are *volume*, *tone*, *balance*, and *front-rear*. When an FM stereo station is being received, the green indicator light on the face of the adapter will light.

The multiplex adapter uses the same stereo speaker diagnosis of the balance and front-rear controls, and the speaker system are identical to the tape player system. Refer to tape player trouble diagnosis for checking.

Refer to Figs. 15-5 and 15-6 in the 1967 Pontiac Service Manual for diagnosis of reception complaints. Whenever the AM-FM radio is removed for service, the multiplex adapter should also be sent to the radio service station, since the problem could originate

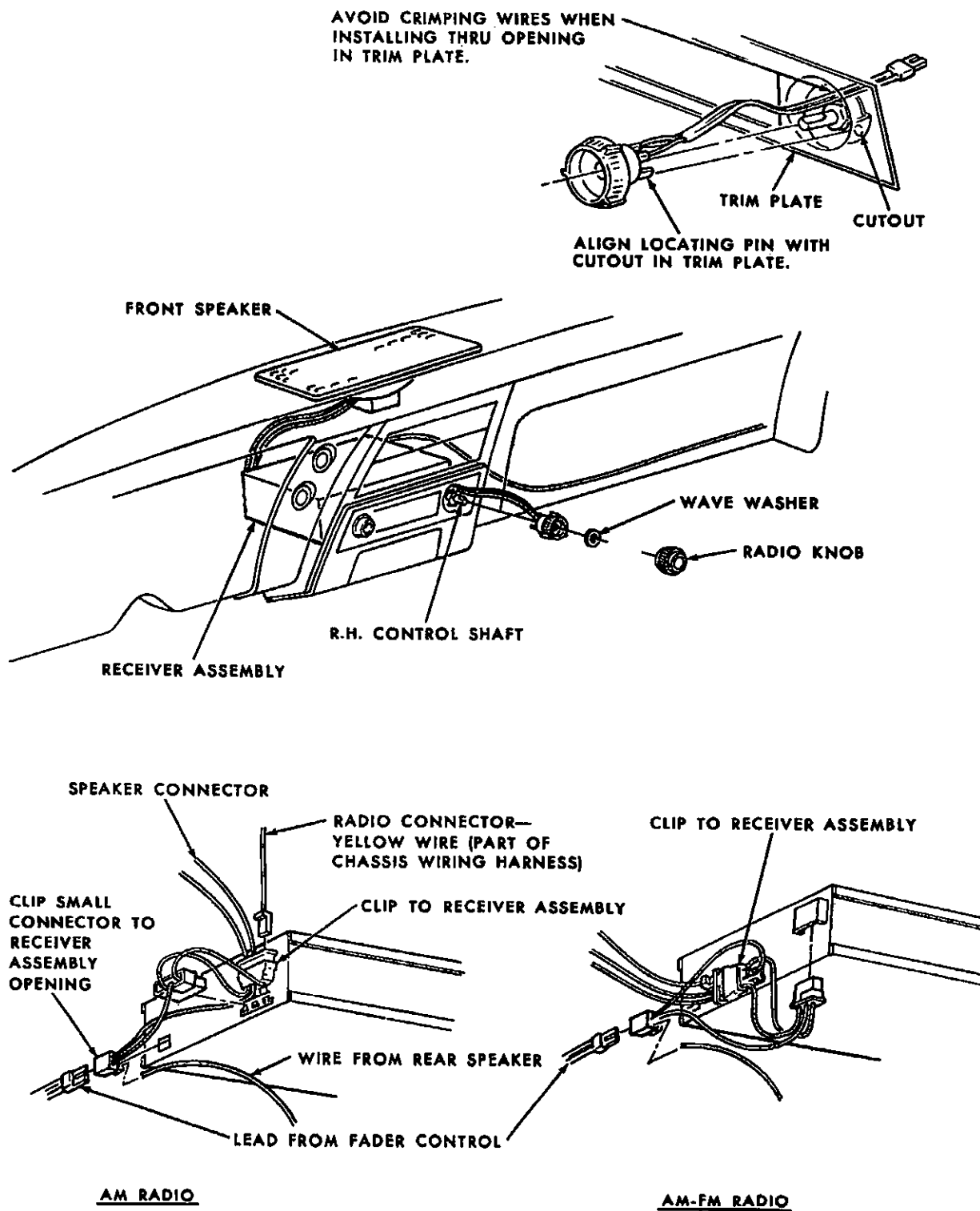

Fig. 15-12 Rear Speaker Controls

in either unit. (This would not be necessary where the complaint is restricted to the AM band alone).

CAUTION: Never operate AM-FM radio without either a multiplex adapter plug or jumper plug (G.M. part 7292146 or equivalent) plugged into radio receiver.

MULTIPLEX ADAPTER-REMOVE AND REPLACE

1. Disconnect adapter plug from bottom of radio receiver (see Fig. 15-10).
2. Unclip ground wire from speaker bracket (above radio).
3. Disconnect power feed to radio (yellow wire) - (black wire when also equipped with tape player).

4. Disconnect adapter connector from back of radio receiver.

5. Disconnect six-wire speaker connector from stereo speaker connector (or from connector to multiplex-tape player switch-connector C in figure 15-9 if also equipped with tape player).

6. Remove four screws holding multiplex adapter to I.P. bracket, and slide adapter out.

7. To install-reverse above procedure.

MULTIPLEX - TAPE PLAYER SWITCH

When stereo FM and stereo tape player are used together on the same vehicle, a switch is installed in the lower instrument panel to switch speakers from

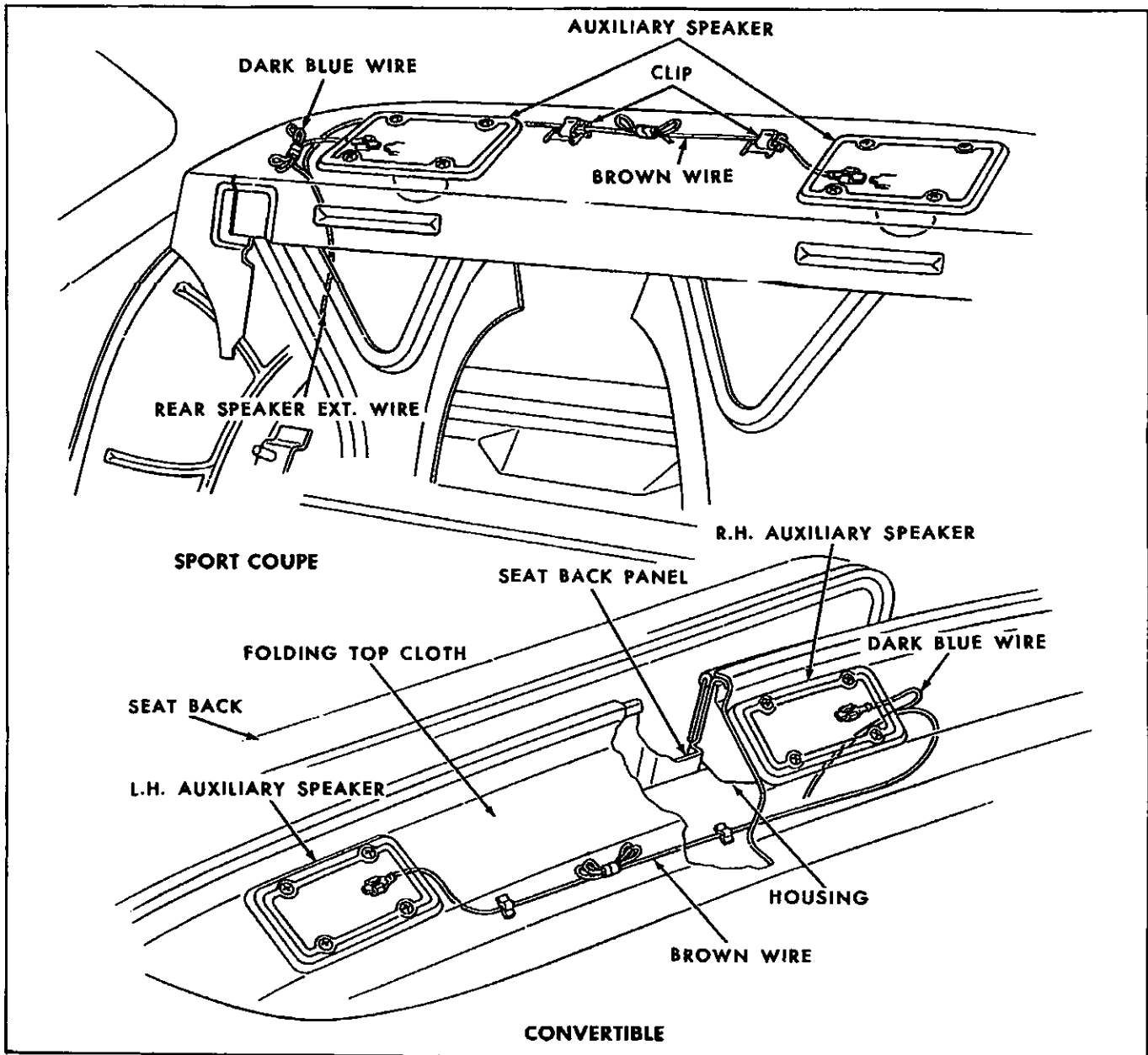

Fig. 15-13 Stereo Rear Speaker Wiring

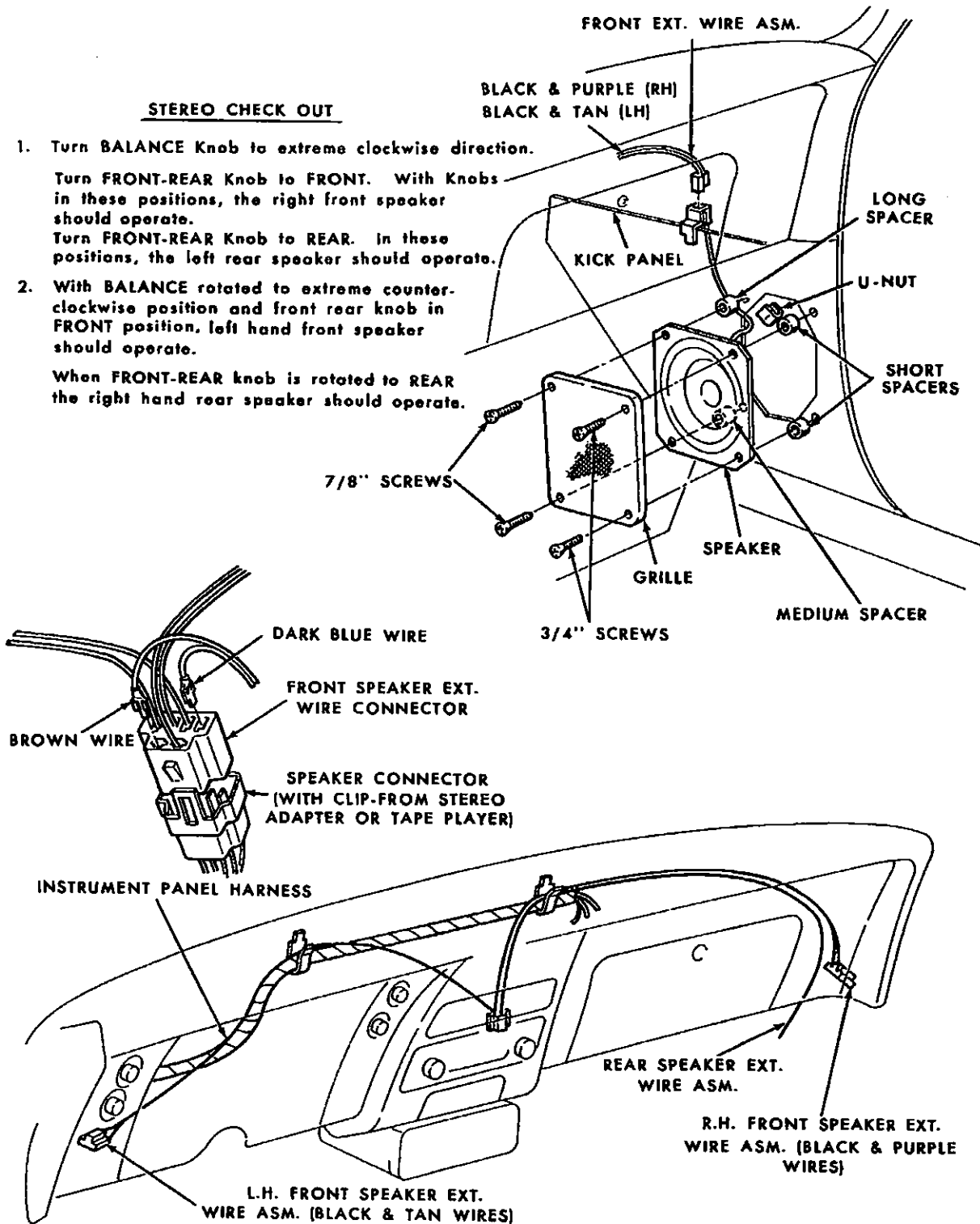

Fig. 15-14 Stereo Front Speaker Wiring